

Key:
 Water filled barriers (160m)

Proposed temporary suspension of parking bays to create wider footways .
 6 P & D
 Loading bay to remain in place

Note:
 * All Bus Stops to be kept clear for access

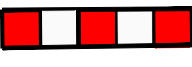
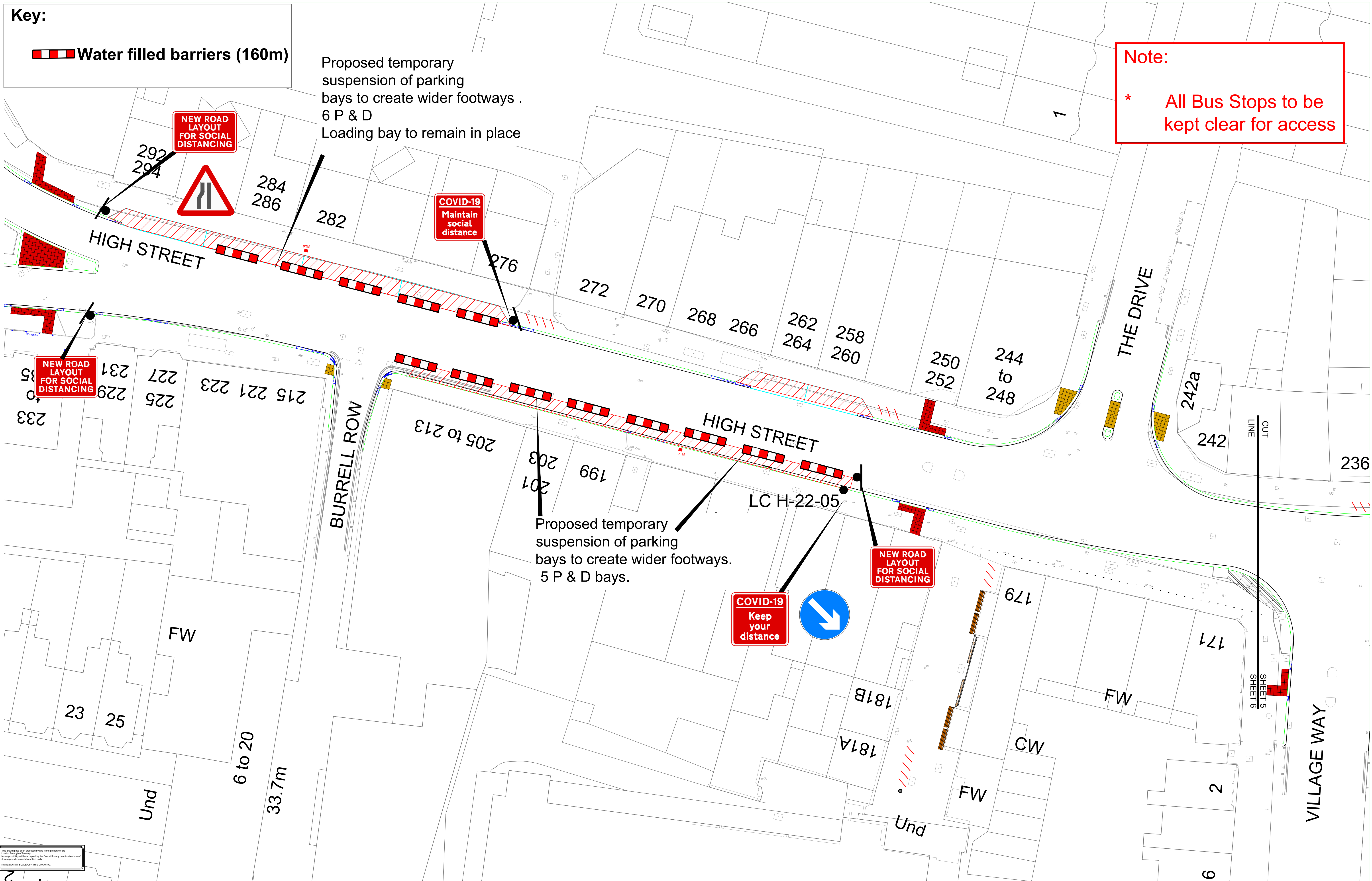

This drawing has been prepared for use in the property of the Council. It is not to be used for any other purpose without the written consent of the Council. It is not to be used for any other purpose without the written consent of the Council. It is not to be used for any other purpose without the written consent of the Council.

